

graceWORKS ! GOING DEEPER¹ The Papou Study Bible is a daily study provided by me to



help folks explore the depth and joy of the “conneXion” life of God. It’s my personal study, and is not intended as a doctrinal statement or statement of any church or denomination or congregation. It’s also my belief that “grace” works, and the servant of God should always want to go deeper. Multi-tasking as usual, I’m also calling this the “Papou Study Bible.” I’m writing it as if I were speaking to my girls who love me and any descendant they have that love their Papou too. And to anyone who wants to consider me a spiritual Dad or “Papou.” I want them to be able to study the Bible with Papou (grandpa in Greek) after I’m gone---and if they don’t, I’ll haunt them. The Scriptures say it’s noble to “search the Scriptures daily” to verify truth like the ancient Bereans did (Acts 17:11). My folks came from Berea. My incredible Dad (and your grandfather and great grandfather, guys), Vasil Charles Valekis taught me to do this like he did---every day until I die. He taught me and everyone I know to go to church no matter what and to put God first. While Mama (Maria Pagona Stratakis Valekis) never really did this, she made sure we listened to Daddy on this one. She would have hit us with a spatula or frying pan or worse if we didn’t. This is a simple sharing my “daily search.” And I’d like to think it is a continuation of God’s life through my Dad through me. Both my “Dads” by the way. And a way to honor him, mama and our loving “Dad”---God. And for all of us to be together, in Spirit, even when we I join them in heaven. I like to use the Blue Letter literal, very “visual,” Greek translation a lot to help “visualize” these truths the beautiful way Greek enables you to view. And I like to share this with folks serving in an elder capacity, or any capacity, to grow them, challenge them, and stretch them. But especially share it with anyone I’ve ever brought to Christ and family members who truly love me. And when you study these, I’ll make sure to connect with you from heaven. *Ever an orthodox Greek, Jim Valekis*

ChristINYouSeries

Colossians 1:27 (King James Version)

²⁷To whom God would make known what is the riches of the glory of this mystery among the Gentiles; which is **Christ in you**, the hope of glory

graceWORKS! GOING DEEPER

Ezekiel 40 Part 3²



So we are going into the heavenly vision of the Temple given to Ezekiel, step by step. I’m taking sort of an “Indiana Jones” approach, discovering this amazing treasure one step at a time. It’s kind of neat digging through the Scripture for this buried treasure. It reminds me of this saying of Jesus (Matthew 13:52).

He said to them, “Therefore every teacher of the law who has become a disciple in the kingdom of heaven is like the owner of a house who brings out of his storeroom **new treasures** as well as **old.**”

To me the Bible is a treasure trove. The more you dig in and study, the more you learn and grow. God and Christ are my Temple. But they’ve given us this Temple with detailed dimensions to study. What do they want us to learn? Let’s dig in.

¹ **NOT TO BE REPRODUCED OR UPLOADED TO WEB WITHOUT EXPRESS PERMISSION OF AUTHOR.**

² New International Version (NIV) Holy Bible, New International Version®, NIV® Copyright ©1973, 1978, 1984, 2011 by Biblica, Inc.® Used by permission. All rights reserved worldwide. (Author’s note: This translation, and the source for many of the study notes that accompany it, are taken from The NIV Study Bible, Copyright 1985,1995, 2002, 2008, 2011 . These notes are referenced throughout and paraphrased frequently in the notes.)

Schematic of Temple³

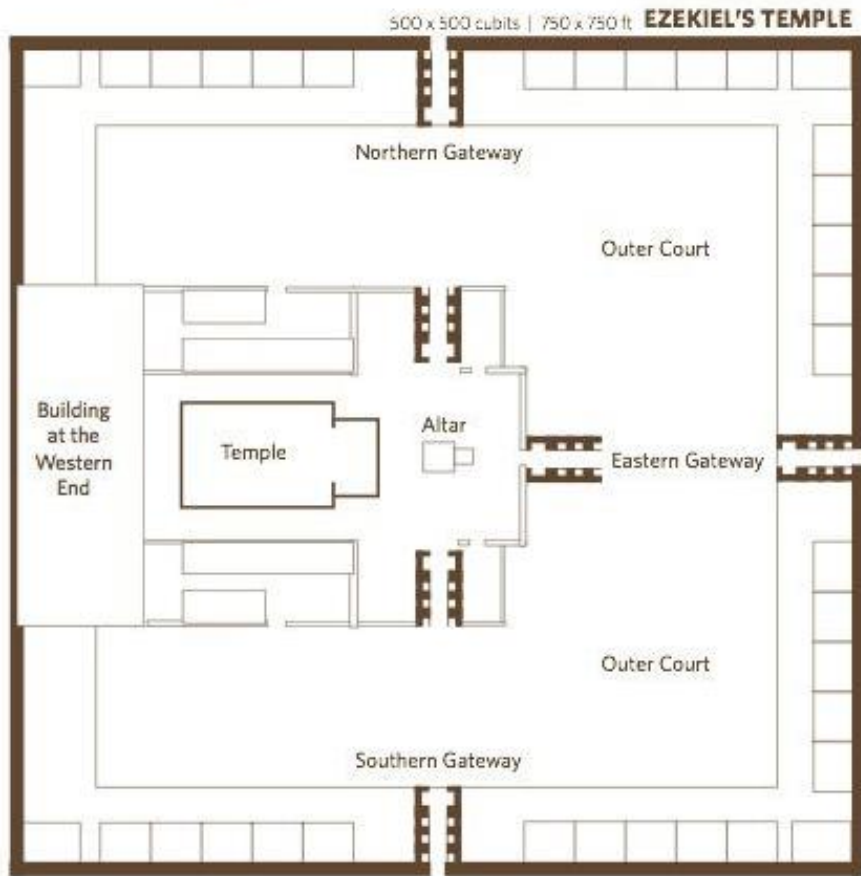

Ezekiel 40 continued.

Let's pick up where we left off.

¹⁰ There were three recesses on each side of the east gate, each with the same measurements, and the jambs on either side also had the same measurements. ¹¹ Then he measured the width of the gate's entrance; it was $17\frac{1}{2}$ feet, while the width of the gate was $22\frac{3}{4}$ feet. ¹² There was a barrier of 21 inches in front of the recesses on both sides, and the recesses on each side were $10\frac{1}{2}$ feet square. ¹³ Then he measured the gate from the roof of one recess to the roof of the opposite one; the distance was $43\frac{3}{4}$ feet. The openings of the recesses faced each other. ¹⁴ Next, he measured the porch—105 feet. ¹⁵ The distance from the front of

the gate at the entrance to the front of the gate's portico on the inside was $87\frac{1}{2}$ feet. ¹⁶ The recesses and their jambs had beveled windows all around the inside of the gate. The porticoes also had windows all around on the inside. Each jamb was decorated with palm trees.

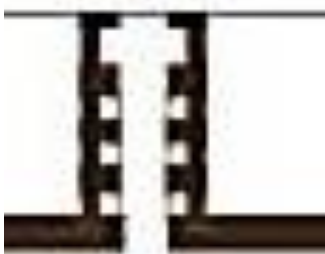

I can't exactly picture this, but this drawing helps. I'm fascinated by the "palm tree" motif.

Perhaps each part of the world reflects something predominate in nature in their architecture. Perhaps "palm tree" hinted of an "oasis." That's an interesting thought. God's Temple, where God is, is a refuge, and oasis from this world's harshness. It is a place of coolness and refreshment. That reminds me of this Scripture about Christ, our Temple.

Acts 3:19

Repent ye therefore, and be converted, that your sins may be blotted out, when the **times of refreshing** shall come from the presence of the Lord.

³ <https://i.pinimg.com/originals/34/09/c1/3409c11284abfe52fc0e88c30e4ce6e8.jpg>

I like the phrase “times of refreshing.” Here is how the more literal phrase reads as transliterated in the Greek.

3:19	μετανοησατε	ουν	και	επιστρεψατε	προς	το	εξαλειφθηναι	υμων	τας
	metanoEsate	oun	kai	epistrepsate	pros	to	exaleiphthEnai	humOn	tas
	after-MIND-YE	THEN	AND	ON-TURN-YE	TOWARD	THE	TO-BE-OUT-RUBBED	OF-YE	THE ^(p)
	repent ^(p) !	then	and	turn-about ^(p) !	toward	the	to-be-erased	of-you ^(p)	the
	αμαρτιας	οπως	αν	ελθωσιν	καιροι	αναψυξεως	απο	προσωπου	του
	hamartias	hopOs	an	elthOsin	kairoi	anapsuxeOs	apo	prosOpou	tu
	misses	WHICH-how	EVER	THEY-MAY-BE-COMING	SEASONS	OF-UP-COOLing	FROM	face	OF-THE
	sins	so-that	ever	may-be-coming	seasons	of-refreshing	from	face	of-the
	κυριου								
	kuriou								
	Master								
	Lord								

When I look up “refreshing” in the Greek, it brings up this word.

G403 anapsuxis an-aps'-ook-sis

from **G404**;

properly, a recovery of breath, i.e. (figuratively) revival.

Its root word, G404, is cool---pun intended.

G404 anapsucho an-aps-oo'-kho

from **G303** and **G5594**;

properly, to cool off, i.e. (figuratively) relieve.

“Ana” means “again.” Psucho means.

G5594 psucho psoo'-kho

a primary verb;

to breathe (voluntarily but gently, thus differing on the one hand from **G4154**, which denotes properly a forcible respiration; and on the other from the base of **G109**, which refers properly

to an inanimate breeze), i.e. (by implication, of reduction of temperature by evaporation) to chill (figuratively).

Wow. We chill with the Lord. How amazingly cool.

¹⁷ Then he brought me into the outer court, and there were chambers and a paved surface laid out all around the court. Thirty chambers faced the pavement,

The NIV Study Bible says:

The exact location of these rooms is not given. They were probably intended for the people's use.

Jeremiah 35: 2-4	NIV Note
<p>² “Go to the Rekabite family and invite them to come to one of the side rooms of the house of the LORD and give them wine to drink.”</p>	<p>These rooms were used for either storage or living quarters.</p>
<p>³ So I went to get Jaazaniah son of Jeremiah, the son of Habazziniah, and his brothers and all his sons—the whole family of the Rekabites. ⁴ I brought them into the house of the LORD, into the room of the sons of Hanan son of Igdaliah the man of God. It was next to the room of the officials, which was over that of Maaseiah son of Shallum the doorkeeper.</p>	<p>1 Kings 6:5 (NIV) ⁵ Against the walls of the main hall and inner sanctuary he built a structure around the building, in which there were side rooms. 1 Chronicles 28:12 ¹² He gave him the plans of all that the Spirit had put in his mind for the courts of the temple of the LORD and all the surrounding rooms, for the treasuries of the temple of God and for the treasuries for the dedicated things. 2 Chronicles 31:11 ¹¹ Hezekiah gave orders to prepare storerooms in the temple of the LORD, and this was done. Nehemiah 13:4-5 ⁴ Before this, Eliashib the priest had been put in charge of the storerooms of the house of our God. He was closely associated with Tobiah, ⁵ and he had provided him with a large room formerly used to store the grain offerings and incense and temple articles, and also the tithes of grain, new wine and olive oil prescribed for the Levites, musicians and gatekeepers, as well as the contributions for the priests.</p>

That’s an interesting survey of these rooms. Let’s continue with what the text says about them. Thirty chambers faced the pavement,¹⁸ which flanked the courtyard’s gates and corresponded to the length of the gates; this was the lower pavement.

Here is a close up of that from our reference drawing.

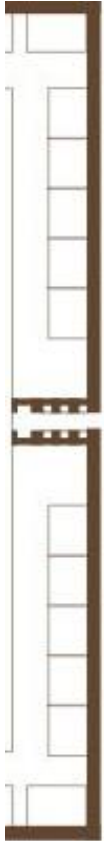

Again, I wonder if they served as offices of some sort as well.

¹⁹ Then he measured the distance from the front of the lower gate to the exterior front of the inner court; it was 175 feet. This was the east; next the north is described.

²⁰ He measured the gate of the outer court facing north, both its length and width. ²¹ Its three recesses on each side, its jambs, and its portico had the same measurements as the first gate: **87½ feet long and 43¾ feet wide.**

It was exactly half as wide as it was long. $43\frac{3}{4} \times 2 = 87\frac{1}{2}$

²² Its windows, portico, and palm trees had the same measurements as those of the gate that faced east. Seven steps led up to the gate, and its portico was ahead of them. ²³ The inner court had a gate facing the north gate, like the one on the east. He measured the distance from gate to gate; it was 175 feet.

²⁴ He brought me to the south side, and there was also a gate on the south. He measured its jambs and portico; they had the same measurements as the others. ²⁵ Both the gate and its portico had windows all around, like the other windows. It was 87½ feet long and 43¾ feet wide. ²⁶ Its stairway had seven steps, and its portico was ahead of them. It had palm trees on its jambs, one on each side. ²⁷ The inner court had a gate on the south. He measured from gate to gate on the south; it was 175 feet.

Next we go to the gates of the Inner Court. Let's keep exploring, my friends.